

Soft Dome Tweeter D21/2

Advantages

The D21/2 is the latest version of the classic design which has been in production for more than 14 years. This improved version features many improvements relating to the interior mechanical design as well as the outstanding sound quality. D21/2 may be used ideally in systems with crossover points higher than 3000 Hz - even with first order filters (6dB per octave) as the flexible lead-in wires allow a low resonant frequency of 1300 Hz.

Note the wide bandwidth: up to 30kHz! The D21/2 proves once again that soft textile is still the ultimate material for high performance dome tweeters.

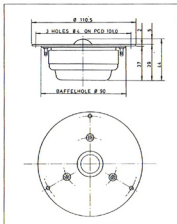
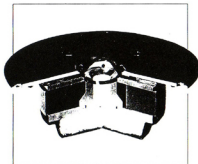

Parameters

Measured in free air and with impedance correction (6R8 / 0.68 uF)

Q, mechanical	Qm	0.7
Q, electrical	Qe	1.1
Q, total	Qt	0.4
Resonance frequency	Fs	1300 Hz
Maximum impedance	Zmax	
Moving mass	Mms	0.35 g
Force factor	BL	3.7 Tm
Equiv. volume	Vas	
Effective cone area	Sd	4.9 cm ²
Lin. excursion (p-p)	Xmax	0.3 mm
Max. excursion (p-p)		2.0 mm

VOICE COIL:

Diameter	d	21 mm
Length	h	2.9 mm
Layers	n	2
Inductance (10kHz)	Le	0.05 mH
Nom. impedance	ZVC	8 Ohms
DC resistance	Re	5.2 Ohms
Sensitivity	2.83V	see curve

POWER HANDLING:

Nominal (long term)	IEC	130 W
Transient	10ms	1000 W
Net weight		570 g
Overall dimensions		Ø111 x 46 mm

Measurements

